

NON-TOTALIZING

IMPORTANT
Before meter can be placed in service "after repair", meter must be tested and approved in accordance with U.S. Government's weights and measures standards.

MODEL	236595 (Pint)	2873 (Liter)
Chamber & Piston Assembly	66871-25	66871-78
Upper Driving Pawl	66871-102	66871-105
Spindle & Gear		
Dial	68314	66871-90

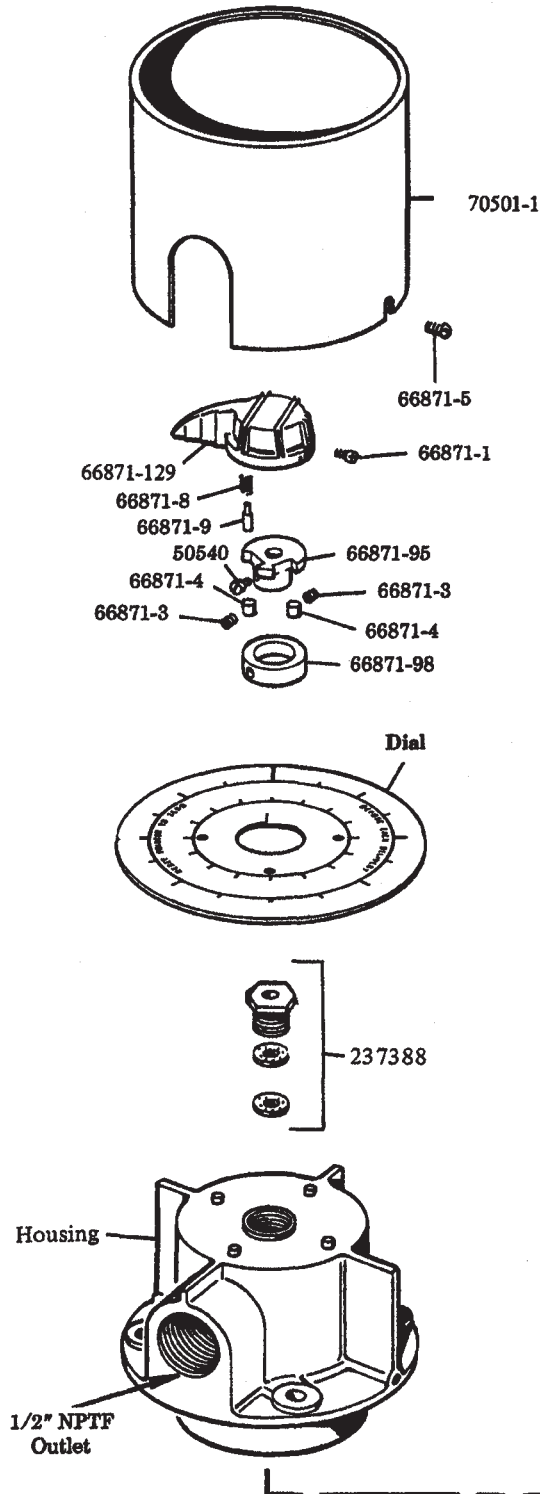

Model 236595©

Model 2873©

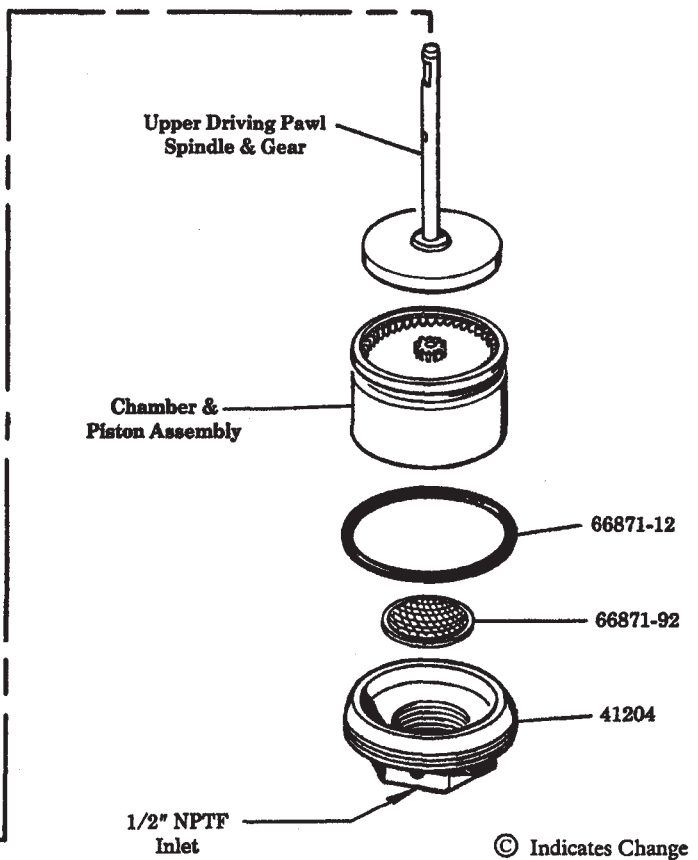
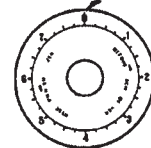
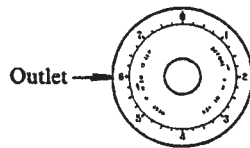

Models 2873 & 236595 METERS



SERVICE PARTS

PART	QUAN.	DESCRIPTION
41204	1	Housing cap
50540	1	Set screw
66871-1	1	Set screw
66871-3	2	Spring-clutch roller
66871-4	2	Reset knob clutch roller
66871-5	2	Shroud screw
66871-8	1	Reset knob plunger spring
66871-9	1	Shoulder pin
66871-12	1	O ^o Ring
237388	1	Packing gland kit
66871-92	1	Filter screen
66871-95	1	Reset lock cam
66871-98	1	Clutch retainer sleeve
66871-129	1	Reset knob
70501-1	1	Shroud

RETAIN THIS INFORMATION FOR FUTURE REFERENCE

When ordering replacement parts, list: Part Number, Description, Model Number, and Series Letter. LINCOLN provides a Distributor Network that stocks equipment and replacement parts. A list of Authorized Service Departments will be furnished upon request.

Americas:
One Lincoln Way
St. Louis, MO 63120-1578
USA
Phone +1.314.679.4200
Fax +1.800.424.5359

Europe /Africa/Middle East
Lincoln GmbH
Heinrich-Hertz-Str. 2-8
69190 Walldorf - Germany
Phone/Fax +49.6227.33-0/-259
www.lincolnindustrial.de

Asia/Pacific:
51 Changi Business Park
Central 2
#09-06 The Signature
Singapore 486066
Phone +65.6588.0188
Fax +65.6588.3438

© Copyright Lincoln Industrial
Corporation 2008
Printed in USA

Web site:
www.lincolnindustrial.com