

Flow guns

Models 774, 775, 776 and 82906

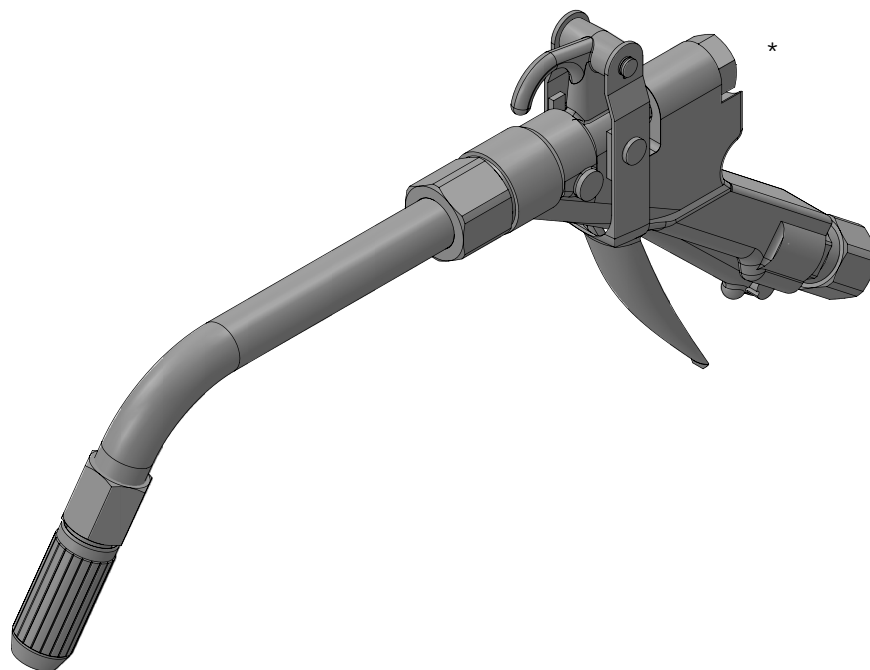

Model 774 shown

Date of issue	May 2023
Form number	404116
Version	2

* Indicates change.

Contents

Safety	3
Explanation of signal words for safety ..	3
Model 774 dimensions*	4
Model 775 dimensions*	4
Model 776 dimensions*	5
Model 82906 dimensions*	5
Operation	6
Non-drip nozzle	6
Troubleshooting*	6
Parts list*	7
Illustrated parts breakdown	8
Warranty	12

* Indicates change.

Safety*

The assembly must be installed, maintained and repaired exclusively by persons familiar with the instructions.

Always disconnect power source (electricity, air or hydraulic) from the equipment when it is not being used.

This equipment generates high pressure. Extreme caution should be used when operating this equipment as material leaks from loose or ruptured components can inject fluid through the skin and into the body. If any fluid appears to penetrate the skin, seek attention from a doctor immediately. Do not treat injury as a simple cut. Tell attending doctor exactly what type of fluid was injected.

Any other use not in accordance with instructions will result in loss of claim for warranty or liability.

- Do not misuse, over-pressurize, modify parts, use incompatible chemicals, fluids, or use worn and/or damaged parts.
- Do not exceed the stated maximum working pressure of the equipment or of the lowest rated component in your system.
- Always read and follow the manufacturer's recommendations regarding fluid compatibility, and the use of protective clothing and equipment.
- Failure to comply may result in personal injury and/or damage to equipment.

Explanation of signal words for safety

NOTE

Emphasizes useful hints and recommendations as well as information to prevent property damage and ensure efficient trouble-free operation.

CAUTION

Indicates a dangerous situation that can lead to light personal injury if precautionary measures are ignored.

WARNING

Indicates a dangerous situation that could lead to death or serious injury if precautionary measures are ignored.

DANGER

Indicates a dangerous situation that will lead to death or serious injury if precautionary measures are ignored.

WARNING

Do not operate equipment without reading and fully understanding safety warnings and instructions.



Failure to follow warnings and instructions may result in serious injury.

CAUTION

Do not operate equipment without wearing personal protective gear.

Wear eye protection. Protective equipment such as dust mask, non-skid safety shoes, hard hat, or hearing protection used for appropriate conditions will reduce personal injuries.

Failure to comply may result in light personal injury.



WARNING



Do not allow fluid to leak onto floor when operating equipment. If spill occurs, clean any fluid on floor before continuing operation.

Failure to comply may result in death or serious personal injury.

* Indicates change.

Fig. 1*

Model 774 dimensions
For dispensing fluids
Maximum operating pressure 1 000 psi

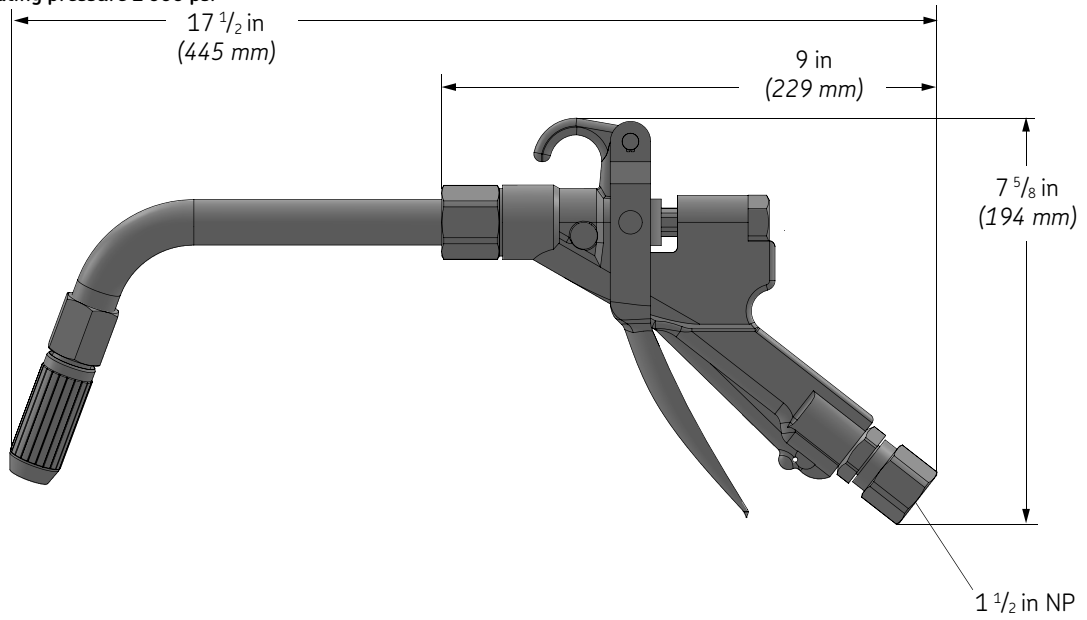

* Indicates change.

Fig. 2*

Model 775 dimensions
For dispensing fluids
Maximum operating pressure 1 000 psi

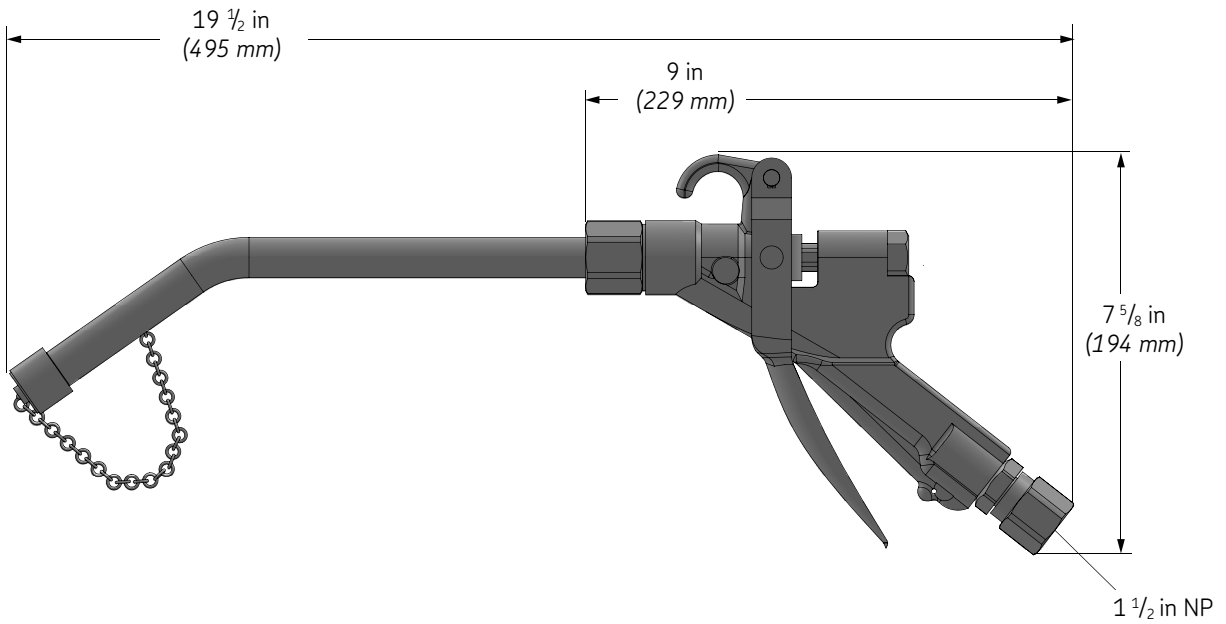

* Indicates change.

Fig. 3*

Model 776 dimensions
For dispensing fluids
Maximum operating pressure 1 000 psi

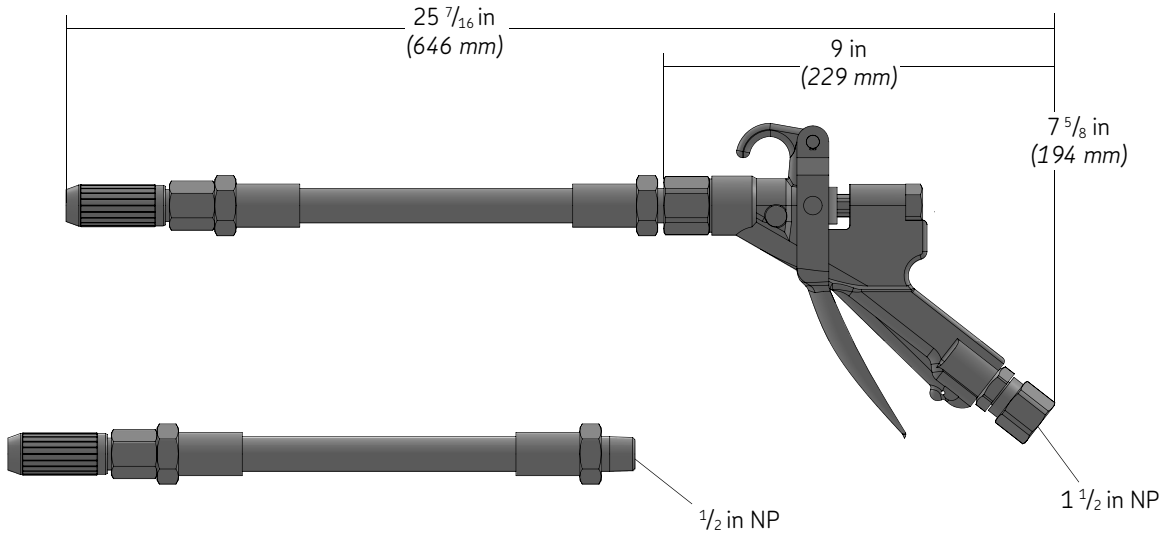

* Indicates change.

Fig. 4*

Model 82906, series "C" dimensions
For dispensing fluids
Maximum operating pressure 1 000 psi

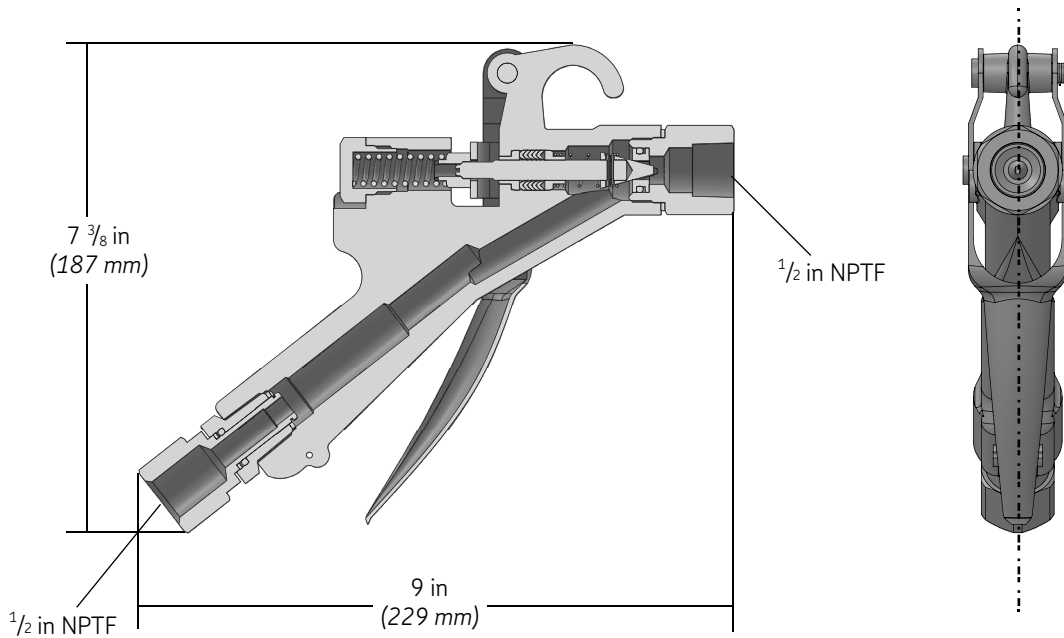

* Indicates change.

Operation

These models are designed to allow complete control over the amount of fluid dispensed.

The control member is a long, contoured trigger with a high level ratio. It can be held in an open position for prolonged periods or triggered repeatedly.

A pivoted latch ring attached to the flow gun body can be used to hold the trigger in the open position for dispensing with an uninterrupted flow. The latch is designed so that it can easily be disengaged and pivoted out of the way when not in use.

Non-drip nozzle

The nozzle tip is threaded hand-tight to the nozzle body to prevent drippage when the flow gun is not in use.

To open nozzle, unscrew nozzle tip until it reaches its stop.

Troubleshooting*

If fluid continues to flow from nozzle when trigger is released, inspect check seat (19) and check needle (22). If foreign particles are visible between check seat (19) and check needle, use a cleaning fluid and stiff brush to clean. Examine check seat (19) and check needle, and replace if worn or damaged.

If fluid is leaking by valve stem (24), this indicates either check stem and/or v-packings (17) are worn. Examine check stem and packings (17), and replace if worn or damaged.

⚠ CAUTION

Do not force nozzle tip beyond its stop.

Be sure nozzle tip is opened before operating flow gun handle.

Failure to comply may result in personal injury or damage to equipment.

⚠ WARNING

Do not allow system dispensing fluid to overpressurize. Systems that will be dispensing fluids under pressure may need to be protected by using a thermal relief kit. This kit will safely limit the pressures caused by thermal expansion. Contact your local SKF representative and refer to manual 430260 for more details.

Failure to include thermal relief protection may cause damage not covered under warranty policy.

Fig. 5*

Non-Drip nozzle 277814 Used with model 774 and 776 flow guns

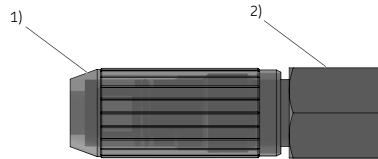

- 1) Nozzle tip
- 2) Nozzle body
- * Indicates change.

* Indicates change.

Parts list*

Item	Description	Part number	Quantity
1	Nozzle assembly	273508	1
2	Flow gun	82906	1
3	Extension	339149*	1
4	Non-drip nozzle	277814*	1
5	Nozzle and cap assembly	82932	1
6	Chain and washer nozzle	92655	1
7	Relief fitting assembly	5680	1
8	Nozzle cap	14920	1
9	Gasket $1\frac{3}{16}$ OD x $\frac{1}{8}$ thick	34567	1
10	Non-drip nozzle assembly	82642	1
11	Hose assembly	273222	1
12	Plug	13357	1
13	Plunger spring	55136	1
14	Spring guide	13358	1
15	Saddle	45844	1
16	Packing washer	13353	2
17	Leather V packing	38095	5
18	Spring	55271	1
19	Check seat	13648	1
20	O-Ring $\frac{1}{2}$ ID x $\frac{1}{16}$ Buna A70	34166	1
21	Adapter	13356	1
22	Check needle	230033	1
23	Pump bushing gasket	31002	1
24	Valve stem	244784	1
25	Roll pin	244787	1
26	Handle	45843	1
27	Lock ring	57093	1
28	Swivel assembly	90464	1
29	Flow gun body	16707	1
30	Pin	13352	1
31	Retaining ring	68530	1
32	Pin	13351	2

* Indicates change.

Model 774

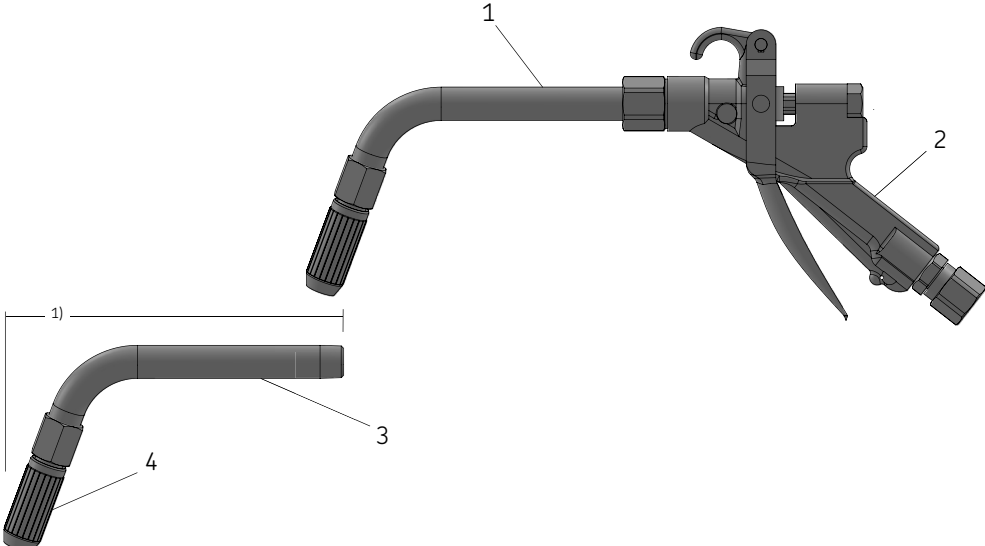

1) Nozzle assembly

* Indicates change.

Model 775

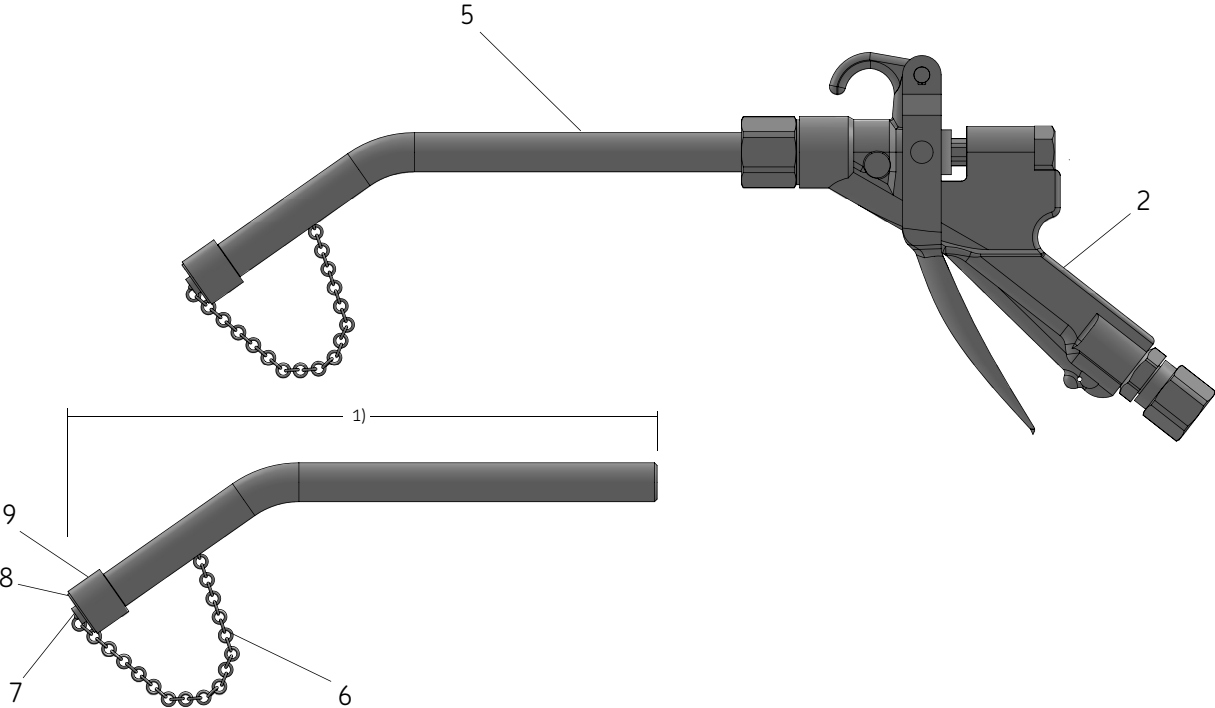

1) Nozzle assembly

* Indicates change.

Model 776

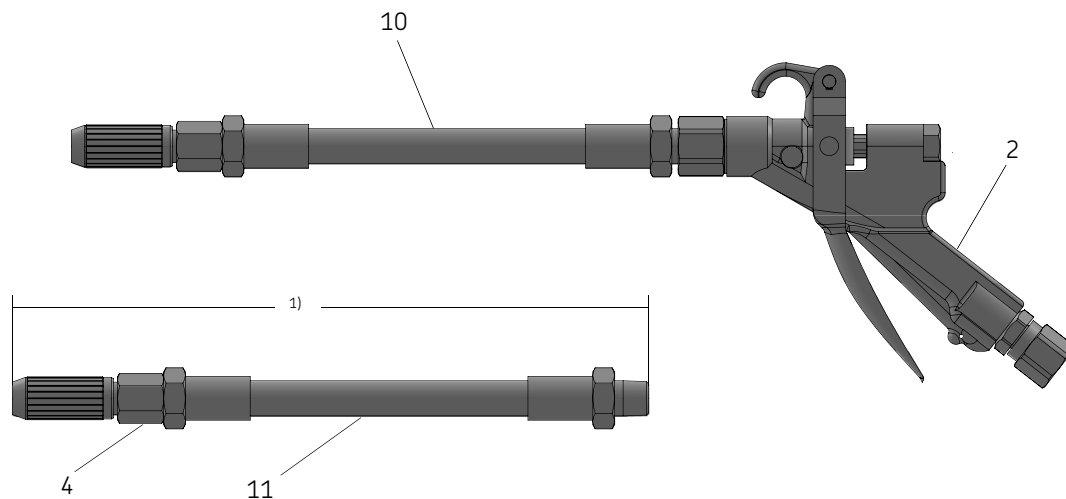

¹⁾ Non-drip nozzle assembly
 * Indicates change.

Model 82906

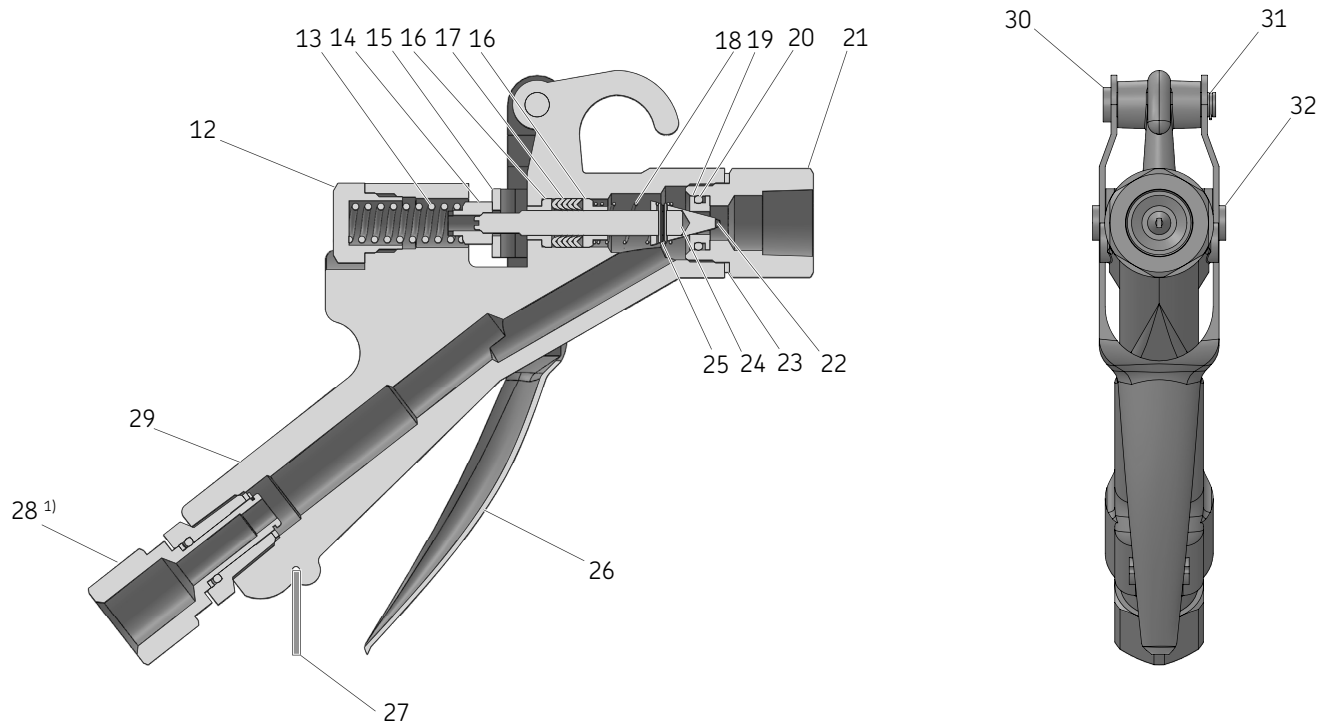

¹⁾ Refer to manual 403221 for swivel 90464.
 * Indicates change.

This page left intentionally blank.

This page left intentionally blank.

Warranty

The instructions do not contain any information on the warranty.
This can be found in the General Conditions of Sales, available at:
www.lincolnindustrial.com/technicalservice or www.skf.com/lubrication.

skf.com | lincolnindustrial.com

© SKF and Lincoln are registered trademarks of the SKF Group.

© SKF Group 2023
The contents of this publication are the copyright of the publisher and may not be reproduced (even extracts) unless prior written permission is granted. Every care has been taken to ensure the accuracy of the information contained in this publication but no liability can be accepted for any loss or damage whether direct, indirect or consequential arising out of the use of the information contained herein.

May 2023 · Form 404116 Version 2