

## 602208 -1/2" PORTS

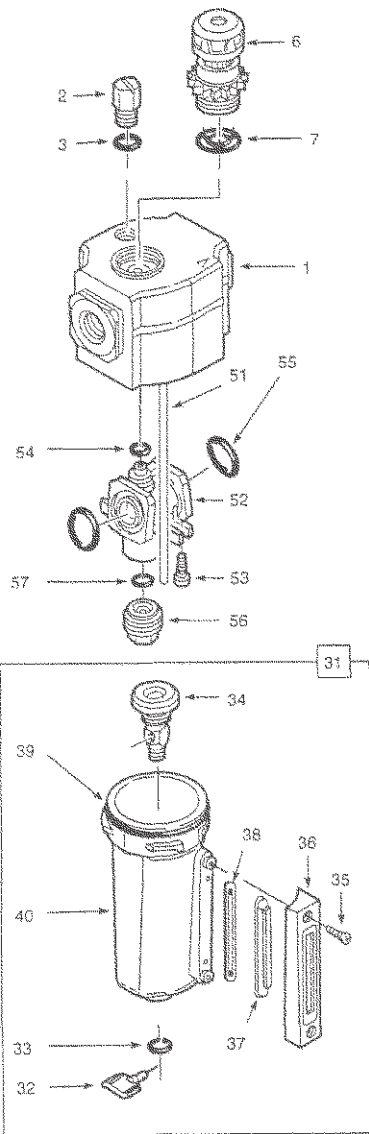

### TECHNICAL DATA

Fluid: Compressed air  
 Maximum pressure: 250 psig (17 bar)  
 Operating temperature: 0° to +175° F (-20° to +79°C)\*

\*Air supply must be dry enough to avoid ice formation at temperatures below 35°F (2°C).

Main parts: 1/2" PTF

Start point (i.e., minimum flow required for lubricator operation): 3.5 scfm (1.7 DM<sup>3</sup>/s) at 90 psig (6.3 bar) inlet pressure

Approximate flow at 90 psig (6.3 bar) inlet pressure and 7 psid (0.5 bar) pressure drop: 144 scfm (68 dm<sup>3</sup>/s)  
 Nominal reservoir size: 7 fluid oz (0.2 liter)

### Materials:

Body: Aluminum  
 Reservoir: Aluminum  
 Liquid level indicator lens: Transparent nylon  
 Sight feed dome: Transparent nylon  
 Elastomers: Neoprene and nitrile

### REPLACEMENT ITEMS

Service kit (3, 7, 39).....247881  
 Liquid level lens kit (35, 37, 38, 39).....247876  
 Manual drain (32, 33, 34).....247893  
 Sight feed dome (6, 7).....247933

### INSTALLATION

1. Install lubricator vertically in air line
  - downstream of filters and regulators,
  - upstream of cycling valves,
  - with air flow in direction of arrow on body,
  - as close as possible to the device being lubricated.
2. Connect piping to proper ports using pipe thread sealant on male threads only. Do not allow sealant to enter interior of unit.
3. Fill reservoir with a good quality, light, misting type oil for compressed air tools. Oil level must always be visible in lens (37). **DO NOT OVERFILL.**
4. Turn reservoir fully clockwise into body before pressurizing.
5. Manual drain is ported 1/8-27 and 1/8-28 pipe thread.

### REFILL RESERVOIR WITH OIL

Shut off inlet pressure and reduce pressure in reservoir to zero. Remove fill plug (2), add oil, and reinstall fill plug. *Do not remove the fill plug when the reservoir is pressurized, as oil will blow out the fill plug hole.*

### ADJUSTMENT

1. Turn on system pressure.
2. Adjust lubricator drip rate only when there is a constant rate of air flow thru the lubricator. Monitor drip rate thru sight feed dome (6).
3. Determine the average rate of flow thru the lubricator. Turn adjusting knob (6) to obtain the recommended drops per minute. See Drip Rate Chart. Turn knob counterclockwise to increase and clockwise to decrease the drip rate. Push red locking on adjusting knob down to lock drip rate setting. Pull locking up to release.
4. Monitor the device being lubricated for a few days following initial adjustment. Adjust the drip rate if the oil delivery at the device appears either excessive or low.

### DRIP RATE CHART

Flow -scfm (dm <sup>3</sup> /s)	Drops per Minute
5 (2.4)	10
10(5)	11
20(9)	13
30(14)	15
40 (19)	17
50 (24)	19
60 (28)	22
70 (34)	24
80 (38)	26
90 (43)	28
100 (48)	30

### DISASSEMBLY

1. Shut oh inlet pressure. Reduce pressure in inlet and outlet lines to zero. Loosen fill plug (2).
2. Remove reservoir - push into body and turn counterclockwise.
3. Disassemble in general accordance with the item numbers on exploded view. Disassemble and replace drain (32, 33, 34) only if it malfunctions. Do not remove items 51 thru 57.

---

**CLEANING**

1. Clean all parts using warm water and soap.
2. Rinse and dry parts. Blow out internal passages in body with clean, dry compressed air.
3. Inspect parts Replace parts found to be damaged.

**ASSEMBLY**

1. Lubricate seals, o-rings, and stem of drain valve (32) with o-ring grease
2. Assemble lubricator as shown on exploded view.

3. Torque Table    Inch-Pounds (N-m)  
6 (dome)        20 to 25 (2.3 to 2.8)  
35 (screw)      13 to 16 (1.5 to 1.8)  
53 (screw)      8 to 10 (0.9 to 1.1)
4. Turn reservoir (40) fully clockwise into body.

**WARNING**

These products are intended for use in industrial compressed air systems only. Do not use these products where pressures and temperatures can exceed those listed under Technical Data.

In lubrication applications some oil mist may escape from the point of use to the surrounding atmosphere. Users are referred to OSHA safety and health standards for limiting oil mist contamination and utilization of protecting equipment

Do not use these products with fluids other than air, for nonindustrial applications, or for life-support systems.

**LIMITED WARRANTY-**

Lincoln warrants the equipment it supplies to be free from defects in material and workmanship for one (1) year following the date of purchase. If equipment proves to be defective during this warranty period it will be repaired or replaced, at Lincoln's discretion, without charge provided that factory authorized examination indicates the equipment to be defective. To obtain repair or replacement, you must ship the equipment, transportation charges prepaid, with proof of date of purchase to a Lincoln authorized warranty and service center, within one (1) year following the date of purchase.

**LIMITED 5 YEAR WARRANTY (Series 20, 25, 40 Bare Pumps, Heavy Duty and Golden Standard Bare Reels)-**

Lincoln warrants series 20, 25, 40 bare pumps, and heavy duty and golden standard bare reels it supplies to be free from defects in material and workmanship for one (1) year following the date of purchase. If equipment proves to be defective during the warranty period it will be repaired, or replaced, at Lincoln's discretion, without charge provided that factory authorized examination indicates the equipment to be defective. To obtain repair or replacement, you must ship the equipment, transportation charges prepaid, with proof of purchase to a Lincoln Authorized Warranty and Service Center within one (1) year following the date of purchase. Additionally, in years two (2) and three (3) the warranty on this equipment is limited to repair with Lincoln paying parts and labor only. In years four (4) and five (5), the warranty on this equipment is limited to repair with Lincoln paying for parts only.

This warranty is extended to the original retail purchaser only. It does not apply to equipment damaged from accident, overload, abuse, misuse, negligence, faulty installation or abrasive or corrosive material, or to equipment repaired or altered by anyone not authorized by Lincoln to repair or alter the equipment. This warranty applies only to equipment installed and operated according to the recommendations of Lincoln or its authorized field personnel. No other express warranty applies.

Any implied warranties applicable to equipment supplied by Lincoln, including the warranties of merchantability and fitness for a particular purpose, will last for only one (1) year from the date of purchase. Some jurisdictions do not allow limitations on how long an implied warranty lasts, so the above limitation may not apply to you.

In no event shall Lincoln be liable for incidental or consequential damages. Lincoln's liability on any claim for loss or damages arising out of the sale, resale or use of equipment it supplies shall in no event exceed the purchase price. Some jurisdictions do not allow the exclusion or limitation of incidental or consequential damages, so the above limitation or exclusion may not apply to you.

This warranty gives you specific legal rights. You may also have other rights that vary by jurisdiction.