

Air regulators

600000 series*

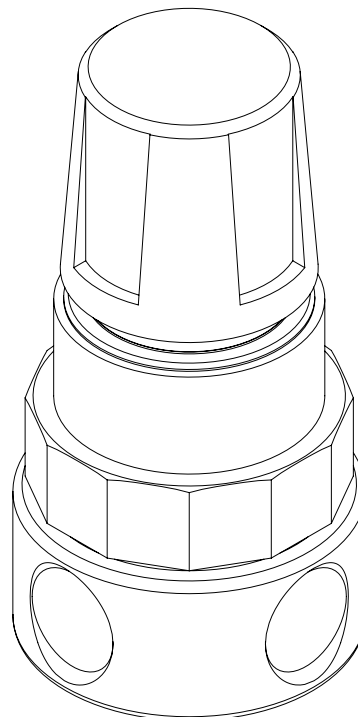
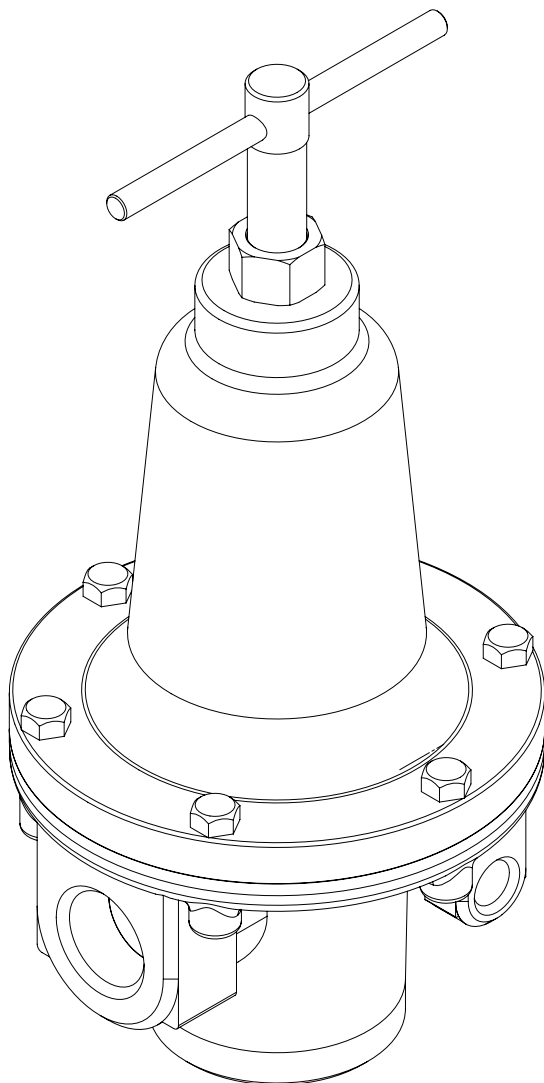

Date of issue	November 2020
Form number	403367
Version	2

* Indicates change.

Contents

Safety	3
Signal words for safety	3
Operating pressures	4
Dimensions	4
Parts	5
Codes	6
Installation and operating instructions	6
Adjustment	6
Maintenance	7
Warranty	8

Safety

Read and carefully observe these installation instructions before installing/operating/troubleshooting the assembly. The assembly must be installed, maintained and repaired exclusively by persons familiar with the instructions.

Install the assembly only after safety instructions and this guide have been read and are completely understood.

Adequate personal protection must be used to prevent splashing of material on the skin or in the eyes.

Always disconnect power source (electricity, air or hydraulic) from the assembly when not in use.

This equipment generates very high grease pressure. Extreme caution should be used when operating this equipment as material leaks from loose or ruptured components can inject fluid through the skin and into the body. If any fluid appears to penetrate the skin, seek attention from a doctor immediately.

Do not treat injury as a simple cut. Tell attending doctor exactly what type of fluid was injected.

Any other use not in accordance with instructions will result in loss of claim for warranty or liability.

- Do not misuse, over-pressurize, modify parts, use incompatible chemicals, fluids, or use worn and/or damaged parts.
- Do not exceed the stated maximum working pressure of the pump or of the lowest rated component in your system.
- Always read and follow the fluid manufacturer's recommendations regarding fluid compatibility, and the use of protective clothing and equipment.
- Failure to comply may result in personal injury and/or damage to equipment.

Explanation of signal words for safety

NOTE

Emphasizes useful hints and recommendations as well as information to prevent property damage and ensure efficient trouble-free operation.

⚠ CAUTION

Indicates a dangerous situation that can lead to light personal injury if precautionary measures are ignored.

⚠ WARNING

Indicates a dangerous situation that could lead to death or serious injury if precautionary measures are ignored.

⚠ DANGER

Indicates a dangerous situation that will lead to death or serious injury if precautionary measures are ignored.

Operating pressures

Models	Primary	Secondary	Maximum temperature
600003	300 psi (21 bar)	0 to 125 psi (0 to 8,6 bar)	120 °F (49 °C)
600004, 600006, 600008, 600012, 600016	300 psi (21 bar)	0 to 250 psi (0 to 17,2 bar)	120 °F (49 °C)

Dimensions

Model	Thread size	1	2	3
600003	1/4 in (0,64 cm)	2 13/16 in (4,6cm)	1 9/16 in (3,97 cm) dia	1/2 in (1,27 cm)
600004	1/4 in (0,645 cm)	6 in (15,2 cm)	3 in dia (7,62 cm)	1 3/8 in (3,5 cm)
600006	3/8 in (0,95 cm)	6 in (15,2 cm)	3 in dia (7,62 cm)	1 3/8 in (3,5 cm)
600008	1/2 in (1,27 cm)	7 in (17,8 m)	3 9/16 in (9,05 cm) dia	1 1/2 in (3,8 cm)
600012	3/4 in (1,91 cm)	10 in (25,4 cm)	4 11/16 in (11,9 cm) dia	1 7/8 in (4,76 cm)
600016	1 in (2,54 cm)	10 in (25,4 cm)	4 11/16 in (11,9 cm) dia	1 7/8 in (4,76 cm)

Fig. 1

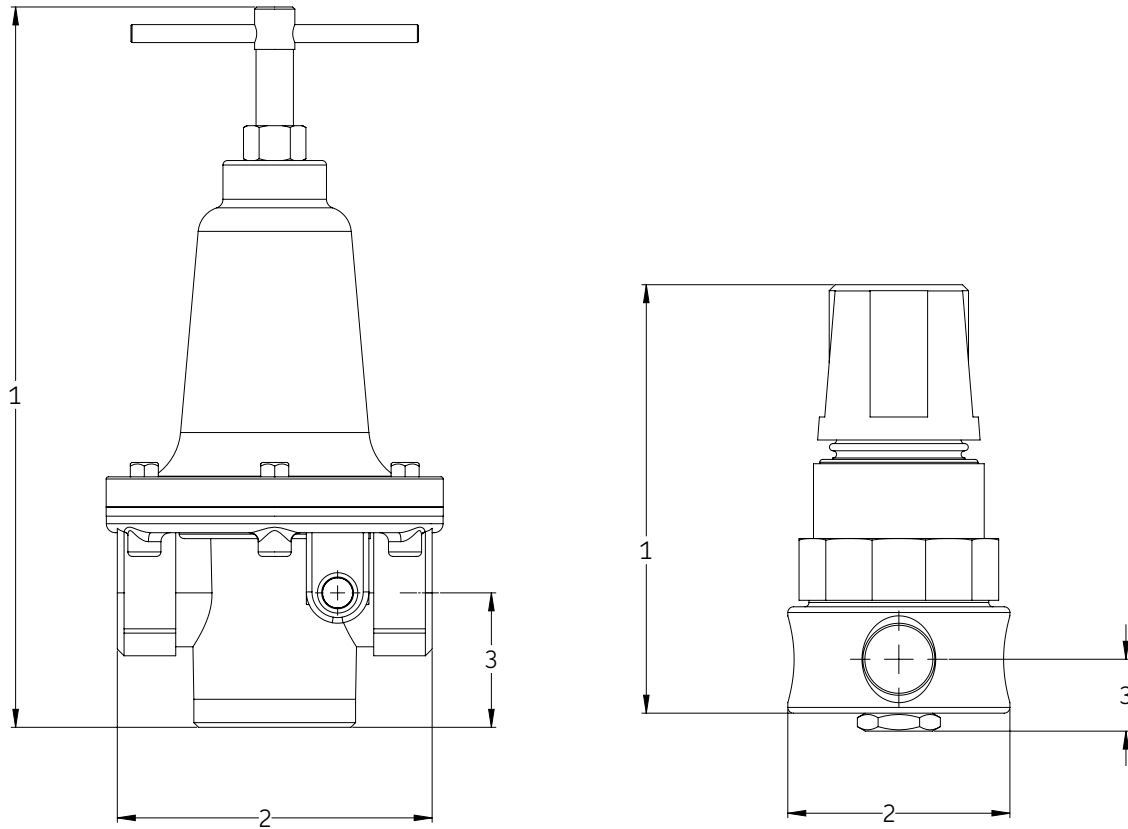

Kits available*					
Kit	Description	600003	600004, 600006	600008	600012, 600016
1	Diaphragm kit Spring	600003-150	600004-150	600008-150	600012-150
2		600003-154	600004-31	600004-31	600012-32

* Indicates change.

Maintenance

To obtain best efficiency and longest periods of trouble-free service, the air supply must be kept clean through the use of a filter ahead of the regulator (→ **fig. 2**).

Clean filter periodically.

1 Inspection: Condition of regulator may be indicated by the regulated pressure.

Regulated pressure-Unsteady regulated pressure or deviation from normal setting usually indicates:

- 1.1** Diaphragm swollen or stiffened-replace diaphragm (**Kit 1**).
- 1.2** Inner valve disc dirty or worn, or seat is scored. Clean or replace (**Kit 1**).
- 1.3** Air line filter may require cleaning or supply valve may be partially closed.

Air leaks through vent in cage.

If constant relief is noted, it may be caused by a dirty or worn inner valve requiring cleaning or replacement (**Kit 1**). Intermittent relief of excess regulated air pressure is normal.

2 Replacement of parts:

Diaphragm:

- 2.1** Release spring tension by turning adjusting tee handle counterclockwise.
- 2.2** Remove 6 flange screws and spring cage.

NOTE

Diaphragm gasket must be in place before replacing spring cage.

2.3 Reassemble new diaphragm assembly (**Kit 1**) to body.

2.4 Tighten cage firmly to body and reset valve as instructed under adjustment.

Inner valve

- 1** Remove bottom plug, strainer, bottom spring and inner valve assembly and wipe seat clean.
- 2** Insert new inner valve assembly.
- 3** Replace bottom spring, bottom plug and strainer.

Fig. 2

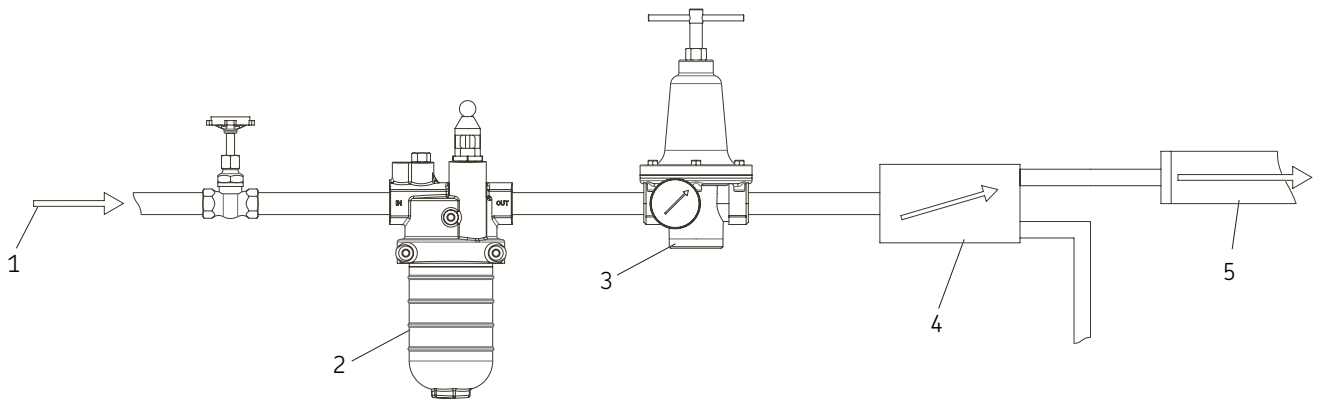

- 1 Air supply
- 2 Filter
- 3 Regulator
- 4 Control
- 5 Cylinder

Installation and operating instructions

In piping up, always be sure pipe ends are reamed to assure a smooth flow.

Before installing regulator:

- 1** Blow out line to remove scale or other foreign matter.
- 2** Apply pipe compound sparingly to male threads only.
 - 2.1** Piping connections are marked on each port on the underside of regulator body (except for Model 600003). Install regulator in line so that air flow is from IN to OUT.
 - 2.2** 1/4 in NPTF hole on sides are for gauge use but may be used for outlet or service purposes.
 - 2.3** Install a shut-off valve ahead of all equipment.
 - 2.4** Install a filter directly ahead of regulator. On air lines, if excessive condensation exists, a condensate trap (automatic type) should be installed.
 - 2.5** Install regulator as close as possible to point of use (equipment) it is supplying.

Adjustment

With relieving type regulators, the regulated pressure may be increased or decreased without venting the regulated pressure system. To increase pressure turn adjusting screw clockwise, to decrease pressure turn screw counterclockwise.

Warranty

The instructions do not contain any information on the warranty.
This can be found in the General Conditions of Sales, available at:
www.lincolnindustrial.com/technicalservice or www.skf.com/lubrication.

skf.com | lincolnindustrial.com

© SKF and Lincoln are registered trademarks of the SKF Group.

© SKF Group 2020
The contents of this publication are the copyright of the publisher and may not be reproduced (even extracts) unless prior written permission is granted. Every care has been taken to ensure the accuracy of the information contained in this publication but no liability can be accepted for any loss or damage whether direct, indirect or consequential arising out of the use of the information contained herein.

November 2020 · Form 403367 Version 2